

Qty: 1 Ref: 13.9-7010
Special Sign

SP1



NOTE: MAN ON SITE TO MAINTAIN ACCESS FOR RESIDENTS

Qty: 2 Ref: 2702 Start of temporary diversion route	
Qty: 1 Ref: 2702 Start of temporary diversion route	
Qty: 2 Ref: 2702 End of temporary diversion route	
Qty: 1 Ref: 2703 Direction of temporary diversion route from junction ahead	
Qty: 1 Ref: 2704 Direction of temporary diversion route	
Qty: 2 Ref: 573 Direction to hazard right	
Qty: 2 Ref: 573 Direction to hazard left	
Qty: 7 Ref: 7001 Road works ahead	
Qty: 2 Ref: 7010-FP-13-9 Nature of temporary hazard ahead - Road Closed	
Qty: 1 Ref: 7010-FP-13-9 Nature of temporary hazard ahead - Road Ahead Closed	

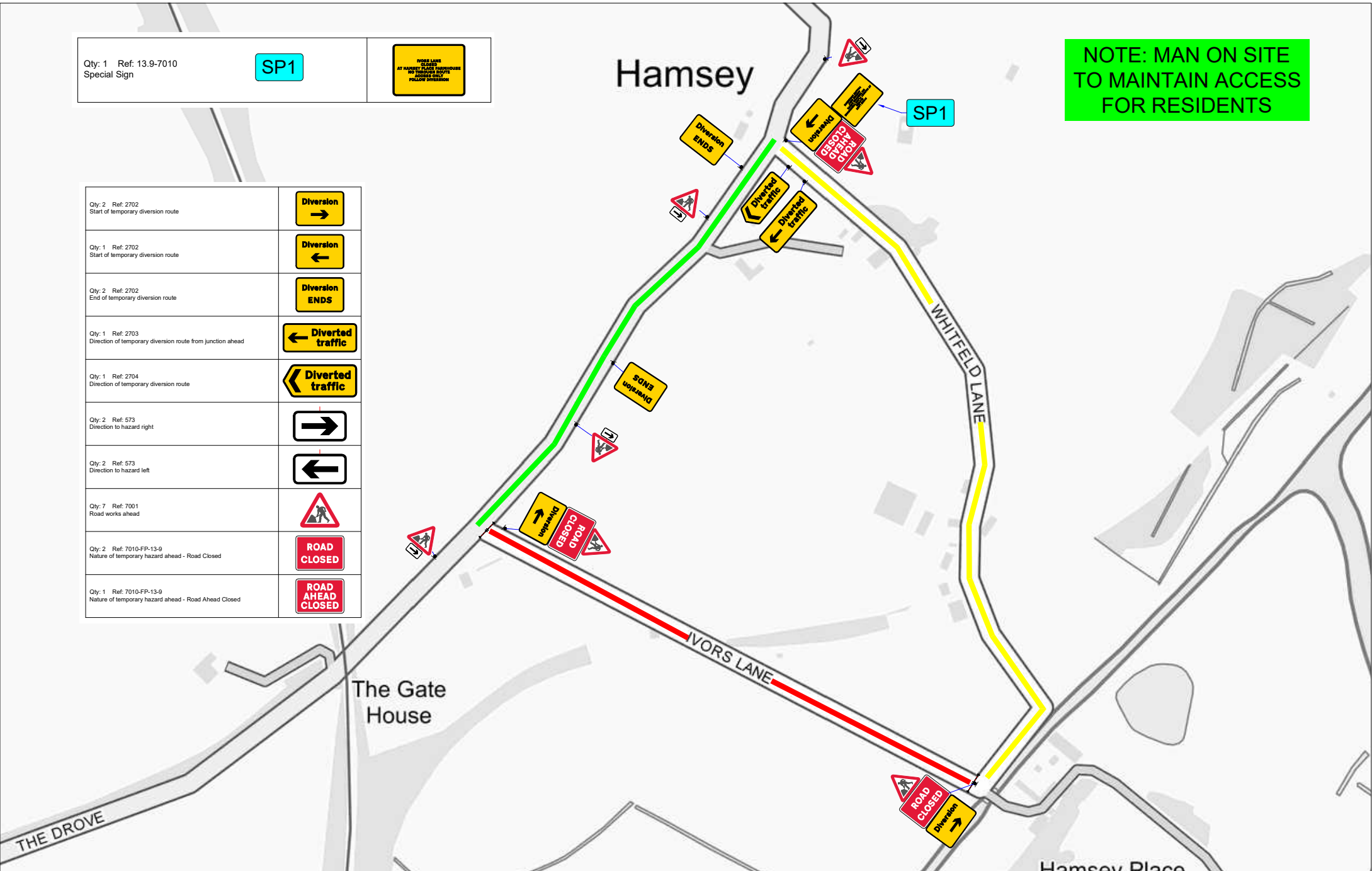

Speed Limit/ Safety Zones

	N
SAFETY ZONE SAFETY ZONE (LONGITUDINAL) (CROSSWAYS)	↓
0.5M	0.5M

Key

	● CONE SIGNS
	— EXTENT OF ROAD CLOSURE
	— ACCESS ONLY
	— DIVERSION ROUTE

Notes

- All dimensions are in metres unless otherwise stated.
- All traffic management to comply with Chapter 8 and any updates, and Safety at Street Works and Road Works (A Code of Practice)
- All road markings and signs to be as per the Traffic Signs Regulations and General Directions 2016.
- All permanent traffic signals will be bagged and switched out, at all times that temporary traffic signals are being used. This should be done with approval from said authority.
- A minimum clearance of 1.5m (absolute minimum 1.0m) to be maintained for pedestrians on footways. If this cannot be maintained signs to be placed in the c/way with associated coning.

HSM
TRAFFIC MANAGEMENT

HIGHWAY SAFETY MANAGEMENT LTD
BEACONSFIELD ROAD
IPSWICH
SUFFOLK, IP1 4AD
01449 745755 (t)
www.highwaysafe.co.uk

Client: **MORRISON Telecom Services**
Agent of Whelping Services

Location: **IVORS LANE, LEWES, BN8 5TA**

Work Details: **934248 - CIVILS WORKS**

Description	Rev.	Date	By
Original Issue for Comments	P1	16/02/22	LR
Revisions	P2		
	P3		
	P4		
	P5		
	P6		
	P7		

Originator	Designer	Checked	Approved
HSM	LR	SB	TC
Scale(s) @ Original Size A3			Date
NOT TO SCALE			FEB 2022
Drawing Number		Revision	
HSM/54720/LR/02		P1	